

HOLE IN P.C.B $\phi 3.5\text{mm}$
THICKNESS: 2.38mm

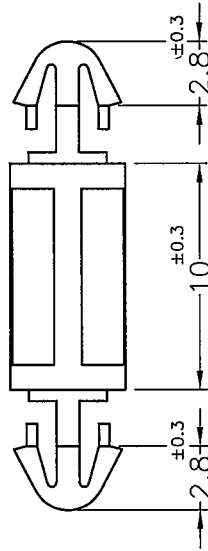

HOLE IN P.C.B $\phi 3.5\text{mm}$
THICKNESS: 2.38mm

- NOTE: 1. SHRINKING IS NORMAL STATUS.
內縮為正常現象.
2. MADE OF EQUIVALENT MATERIAL.
均可使用同等材質.



康揚企業股份有限公司
KANG YANG HARDWARE ENTERPRISE CO., LTD.
康揚塑膠(東莞)有限公司
KANG YANG PLASTIC(DONG GUAN)CO.,LTD.
康哲電腦配件(吳江)有限公司
KANG CHE COMPUTER COMPONENTS(WUJIANG)CO.,LTD.

PROPRIETARY AND CONFIDENTIAL THE INFORMATION CONTAINED IN THIS DRAWING IS THE SOLE PROPERTY OF KANG YANG HARDWARE ENTERPRISE CO. ANY REPRODUCTION IN PART OR AS A WHOLE WITHOUT THE WRITTEN PERMISSION OF KANG YANG HARDWARE ENTERPRISE CO. IS PROHIBITED. DO NOT SCALE DRAWING	DATE	2021.04.28	TITLE	SPACER SUPPORT		DWG. NO.	LCI-10L		PART NO.	LCI-10L	
	DRAWN	Terry		MATERIAL	NYLON 66 UL94V-2		SIZE	A4		SPEC. DWG.	REV
	CHECKED	林祺翔		COLOR	NATURAL		FINISH			A	
	APPROVED	Kang		UNLESS OTHERWISE SPECIFIED TOLERANCE:	SEE ABOVE		SCALE: 3:1	UNIT	mm		SHEET 1 OF 1