

P.C.B ϕ 3.5
THICKNESS E

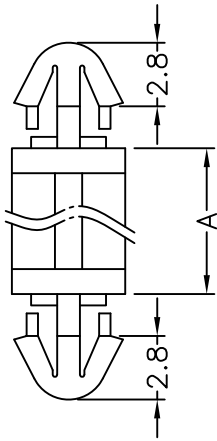

P.C.B ϕ 3.5
THICKNESS F

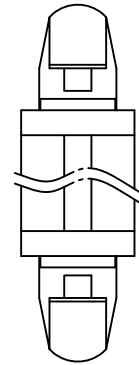

PART NO.	A	E	F
LCI-2.5	2.5	1.2~1.7	1.2~1.7
LCI-3	3.0	1.2~1.7	1.2~1.7
LCI-3.5	3.5	1.2~1.7	1.2~1.7
LCI-4	4.0	1.2~1.7	1.2~1.7
LCI-4.5	4.5	1.2~1.7	1.2~1.7
LCI-5	5.0	1.2~1.7	1.2~1.7
LCI-5.5	5.5	1.2~1.7	1.2~1.7
LCI-6	6.0	1.2~1.7	1.2~1.7
LCI-6.5	6.35	1.2~1.7	1.2~1.7
LCI-7	7.0	1.2~1.7	1.2~1.7

PART NO.	A	E	F
LCI-8	8.0	1.2~1.7	1.2~1.7
LCI-9	9.0	1.2~1.7	1.2~1.7
LCI-10	10.0	1.2~1.7	1.2~1.7
LCI-11	11.0	1.2~1.7	1.2~1.7
LCI-12	12.0	1.2~1.7	1.2~1.7
LCI-15	15.0	1.2~1.7	1.2~1.7
LCI-15(2)	15.0	1.2~2.4	1.2~2.4
LCI-20	20.0	1.2~1.7	1.2~1.7

NOTE:D