

M3X0.5P
BRASS NUT

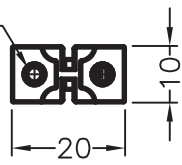

Ø3.3

12

MOUNTING HOLES

A technical drawing showing the mounting holes. Two circular holes are shown with a diameter of $\text{Ø}3.3$. The distance between the centers of the two holes is labeled '12'. The text 'MOUNTING HOLES' is positioned below the drawing.

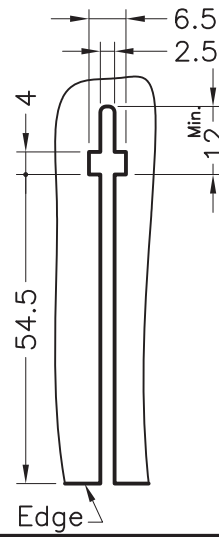

MOUNTING HOLES
THICKNESS:1.6mm