

MOUNTING HOLES

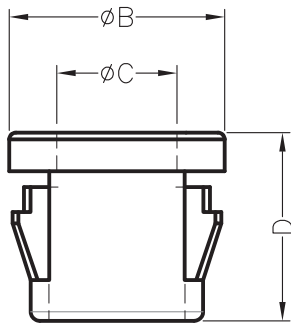

THICKNESS E

PART.NO	A	B	C	D	E
312-3	8.0	9.5	5.2	8.2	0.8~1.8
375-4	9.5	12.0	6.6	10.3	0.8~3.3
0811	11.1	13.6	8.4	10.3	0.8~3.3
0813	12.7	15.1	9.8	10.3	0.8~3.3
1216	16.0	18.2	12.8	10.3	0.8~3.3